

# Electric Movement Replacement

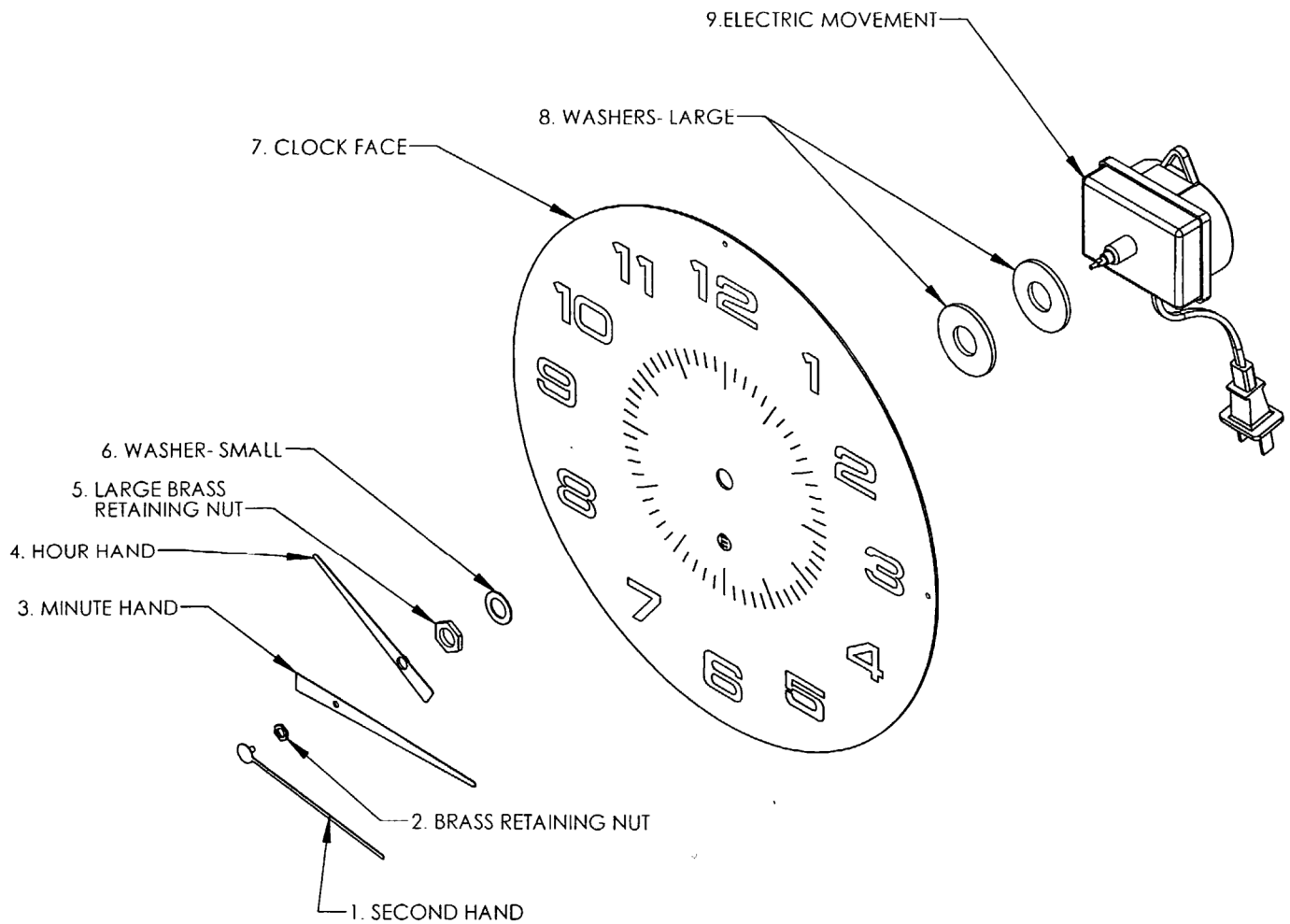

## DISASSEMBLY

1. Remove the second hand (1) by pulling from center shaft.
2. Remove the brass retaining nut (2). We suggest using needle nose pliers.
3. Remove the minute (3) and hour (4) hands by pulling from the center shaft.
4. Remove the large brass retaining nut (5) with an adjustable wrench.  
**NOTE: Take care not to scratch the face.**
5. Remove the small black washer (6).

The old movement can now be removed from the face.

## RE-ASSEMBLY

The new movement can be installed by following the reversing the steps above.