

Model GB | Glass Board Installation Guide

Distance from board edge to standoff:



We recommend mounting the pen rail 3 - 4" below board.

Mounting Instructions

1. Locate desired height of the Glass Board
2. Drill top and bottom holes providing equal spacing from the ends.

BOARD WIDTH	NUMBER OF STANDOFFS
<60"	4
60" - 72"	6
73" - 96"	8

3. Mount bottom standoffs.
4. Place Glass Board onto bottom standoffs and tighten set screws.
5. Attach top standoffs and tighten set screws.
6. We suggest mounting the pen rail between 3 and 4 inches below the bottom of the Glass Board.

IMPORTANT - DO NOT OVERTIGHTEN SET SCREWS. Set screws should only be tightened until the board no longer rattles in the groove. Serious damage can result if additional force is present.

Standoffs

Diameter = 1"
Depth = 1 1/16"

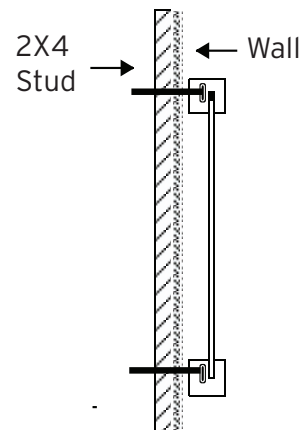
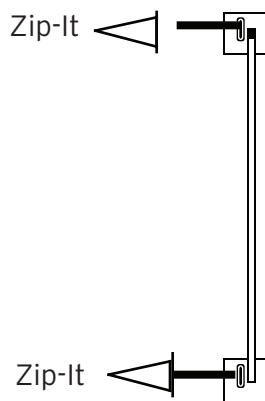
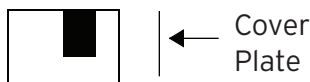
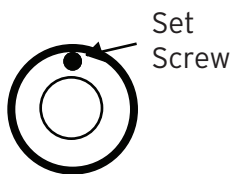

NOTE:

INCLUDED HARDWARE IS FOR DRYWALL INSTALLATIONS ONLY. OTHER SURFACES WILL REQUIRE ADDITIONAL HARDWARE.